

Sechskantmutter

50.2xx PAzzzz

| | |
|------------------|-------------------------|
| Sechskantmutter | Polyamid PA6 GF30 |
| Anschlussgewinde | metrisch, nach EN 60423 |



Eigenschaften

| | | |
|------------------------|-------------|--|
| Temperaturbereich (°C) | -20 +100 | <ul style="list-style-type: none"> zum sicheren Befestigen von Kabelverschraubungen und Zubehörteilen |
|------------------------|-------------|--|

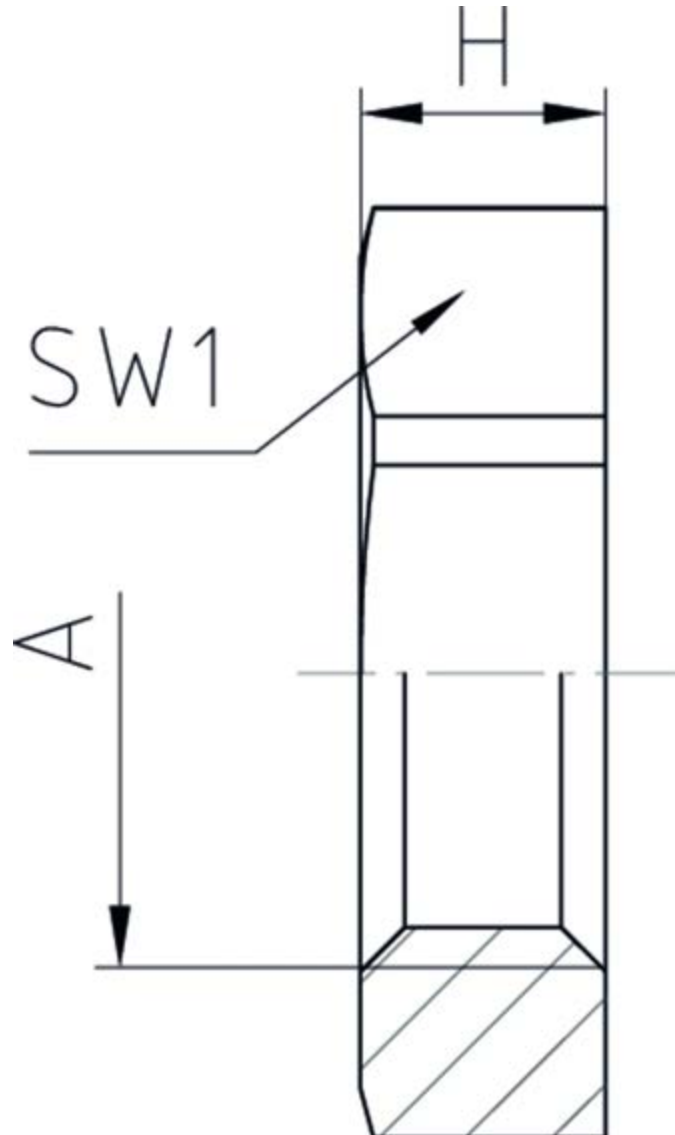

Merkmale

 RAL 9005

| A | SW1 | H |  | Art.-Nr. |
|---------|-----|---|---|--------------|
| M12x1,5 | 17 | 5 | 100 | 50.212 PA/SW |

| A | SW1 | H |  | Art.-Nr. |
|---------|-----|---|---|--------------|
| M16x1,5 | 22 | 5 | 100 | 50.216 PA/SW |
| M20x1,5 | 27 | 6 | 100 | 50.220 PA/SW |
| M25x1,5 | 32 | 6 | 100 | 50.225 PA/SW |
| M32x1,5 | 41 | 7 | 100 | 50.232 PA/SW |
| M40x1,5 | 50 | 7 | 50 | 50.240 PA/SW |
| M50x1,5 | 60 | 8 | 50 | 50.250 PA/SW |
| M63x1,5 | 75 | 8 | 50 | 50.263 PA/SW |



RAL 7035

| A | SW1 | H |  | Art.-Nr. |
|---------|-----|---|---|---------------|
| M12x1,5 | 17 | 5 | 100 | 50.212 PA7035 |
| M16x1,5 | 22 | 5 | 100 | 50.216 PA7035 |
| M20x1,5 | 27 | 6 | 100 | 50.220 PA7035 |
| M25x1,5 | 32 | 6 | 100 | 50.225 PA7035 |
| M32x1,5 | 41 | 7 | 100 | 50.232 PA7035 |
| M40x1,5 | 50 | 7 | 50 | 50.240 PA7035 |
| M50x1,5 | 60 | 8 | 50 | 50.250 PA7035 |
| M63x1,5 | 75 | 8 | 50 | 50.263 PA7035 |



RAL 7001

| A | SW1 | H |  | Art.-Nr. |
|---------|-----|---|---|---------------|
| M12x1,5 | 17 | 5 | 100 | 50.212 PA7001 |
| M16x1,5 | 22 | 5 | 100 | 50.216 PA7001 |
| M20x1,5 | 27 | 6 | 100 | 50.220 PA7001 |
| M25x1,5 | 32 | 6 | 100 | 50.225 PA7001 |
| M32x1,5 | 41 | 7 | 100 | 50.232 PA7001 |
| M40x1,5 | 50 | 7 | 50 | 50.240 PA7001 |
| M50x1,5 | 60 | 8 | 50 | 50.250 PA7001 |
| M63x1,5 | 75 | 8 | 50 | 50.263 PA7001 |

Ab M50x1,5 nicht glasfaserverstärkt