

Hawle-FIT

Einbauanleitung – Fittings / Schieber
Medium Trinkwasser

für PE-Rohre \varnothing d 25 - d 63 bis PN 16

hawle

MONTAGE:

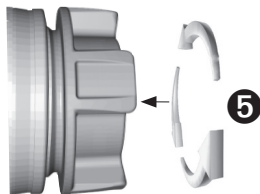
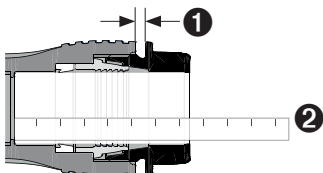

Rohr anschrägen
mit Rohrfräser
Kat.-Nr. 6000

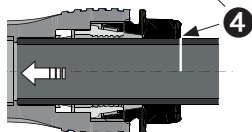
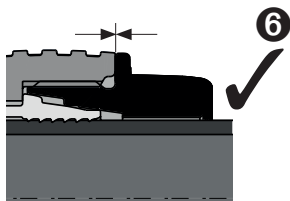
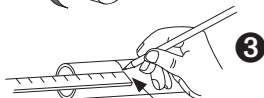

bei Unterdruck mit Stützbüchse



Für PE-Rohre SDR 17 empfehlen wir die
Verwendung einer Stützbüchse Hawle Kat.-Nr. 6021

DEMONTAGE:

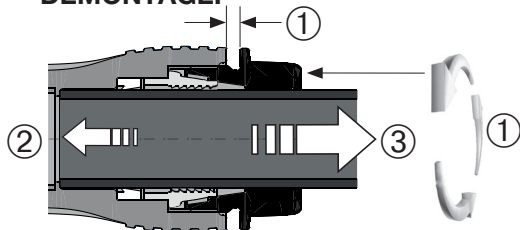

Ohne Werkzeug!
Klemme öffnet
selbsttätig

Hawle-FIT

Instruction – Fittings / Valves

Medium potable water

for PE pipes \varnothing d 25 - d 63 up to PN 16

hawle

ASSEMBLY:

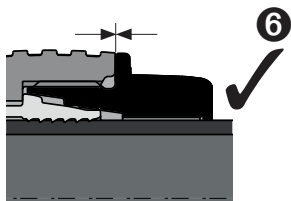
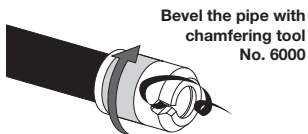
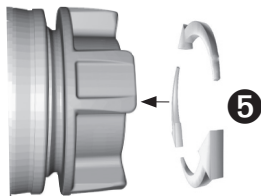
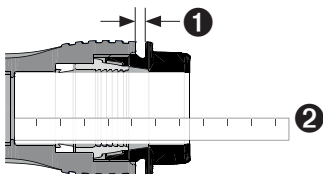

for low pressure with support liner



For PE pipes SDR 17 we recommend a support liner Hawle Cat.-No. 6021

DISMANTLING:

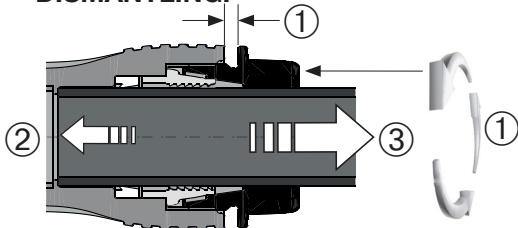

Without tools!
Grip ring opens
automatically